

DESCRIPTION

CAPITAL 300 is the ideal solution for the dramatic illumination of large-scale façades and high-rise buildings calling for high impact lighting. With an industry leading high lumen package, this luminaire effectively satisfies illumination requirements ranging from wall wash applications to enhancement of architectural elements.



Date: _____ Type: _____ Catalog Number: _____

Project Name: _____

ORDERING INFORMATION

LUMINAIRE							
MODEL	CCT	CONTROL	CABLE	VOLTAGE	OPTIC	FINISH	OPTION
CP300 Capital 300	RGBW30K RGBW (3000K White)	DMX-RDM DMX/RDM	S Power in (7.9"), DMX in, DMX out (59")	UNV 120 - 277V	SP Spot 8°	AG Anthracite Grey	AST Anti Saline Treatment
CP300PE Capital 300 Polar Edition	RGBW40K RGBW (4000K White)		M Monocable without Connectors (19.7") C Monocable with Connectors (19.7")		NB Narrow 12°	BL Black	3G 3G Mounting Yoke
					MB Medium 23°	SG Griven Silver Grey	LVR Internal Honeycomb Louver
					WB Wide 43°	WH White	
					EW Extra Wide 58°	CC Custom RAL Color	
					ELH Elliptical Horizontal 42°x 10°		
					ELWH Elliptical Wide Horizontal 39°x 20°		
					WW Wall Wash 36°x 15°		

Custom options are available; consult factory via phone at (864) 487-3535 ext. 258 or via email at DesignServices@EXP-Brands.com.

See Page 5 for ordering information of available accessories.



CAPITAL 300		
PHYSICAL	HOUSING	Die-Cast Aluminum
	OVERALL DIMENSIONS	19.4" L x 4.1" W x 15.1" H
	EPA	1.86 ft²
	WEIGHT	32.4 Pounds
	OPERATING TEMPERATURE	-40°F to 122°F (-40°C to 50°C)
	DRIVER LOCATION	Integral

ELECTRICAL	POWER	256 Watts		
	POWER SUPPLY	100 to 277VAC; 50-60Hz		
	CURRENT	2.13 amps at 120 volts 0.92 amps at 277 volts		
	CONTROL	DMX-RDM, Standalone, Master-Satellite Operation		
	CABLE	S Cable	M Cable	C Cable
		Power In, DMX In, DMX Out Cables	6-Polarity In and Out Power/Data Monocable Without Connectors	6-Polarity In and Out Power/Data Monocable With Connectors
	CABLE LENGTH	59"	19.7"	19.7"

PHOTOMETRIC	LED	RGBW (3000K or 4000K White)		
	DELIVERED LUMEN OUTPUT	up to 16,842 lumens		
	EFFICACY	up to 66 lumens per watt		
	LUMEN MAINTENANCE	L70 > 100,000 Hours at 77°F*		
	LIGHT CONTROL ACCESSORIES	Snoot, Visor, Internal Honeycomb Louver Available		

LIGHT DISTRIBUTIONS	DISTRIBUTION	BEAM ANGLE	RGBW 3000K		RGBW 4000K	
			LUMENS	EFFICACY	LUMENS	EFFICACY
	Spot	8°	15715	61	16201	63
	Narrow	12°	13975	55	14408	56
	Medium	23°	16336	64	16842	66
	Wide	43°	13164	51	13572	53
	Extra Wide	58°	10658	42	10988	43
	Elliptical Horizontal	42° H x 10° V	12885	50	13284	52
	Elliptical Wide Horizontal	39° H x 20° V	12091	47	12465	49
Values based on full output.			Wall Wash	36° H x 15° V with 5° Incline	11073	43
					11416	45

CERTIFICATIONS	SAFETY	ETL Certified for Wet Locations		
	INGRESS PROTECTION	IP67		
	IMPACT RATING	IK09		
	WARRANTY	Limited Five Year Warranty		

* LED life may vary under actual field conditions due to external factors. Lifetime estimates are generated from actual testing in a controlled environment. Values are conservatively derived from those numbers.

DIMENSIONS

All dimensions are shown in inches unless otherwise noted.

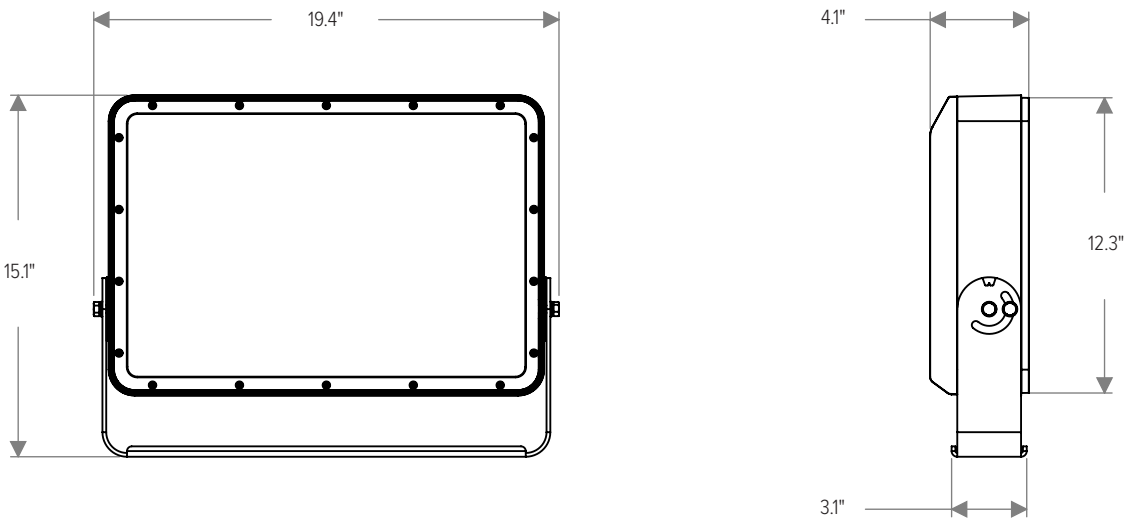

MOUNTING

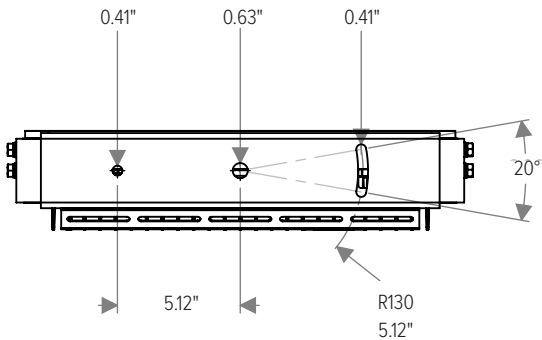

PHOTOMETRICS - RGBW CANDELA DISTRIBUTION

 HORIZONTAL
 VERTICAL

SPOT 8° (SP)

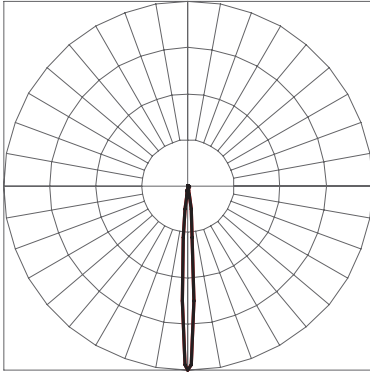

CBCP 505,571 / 12,757 LM

NARROW 12° (NB)

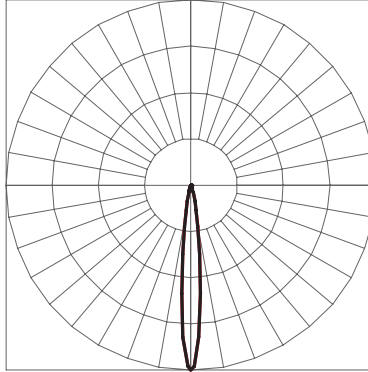

CBCP 170,504 / 11,345 LM

MEDIUM 23° (MB)

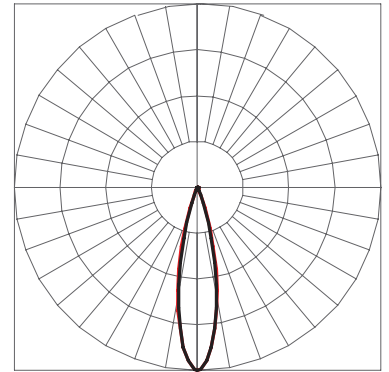

CBCP 58,652 / 10,899 LM

WIDE 43° (WB)

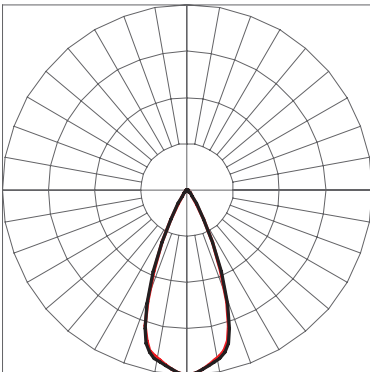

CBCP 19,470 / 10,687 LM

EXTRA WIDE 58° (EXWB)

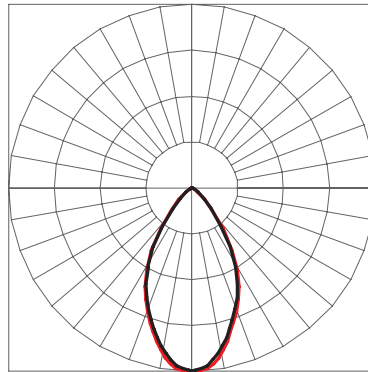

CBCP 9,037 / 8,652 LM

WALL WASH 36° x 15° (WW)

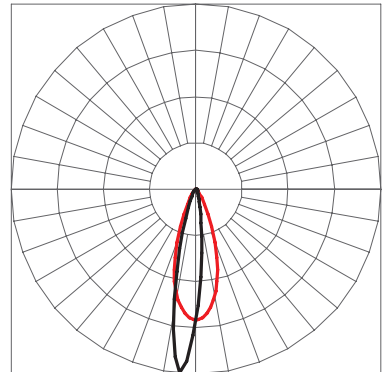

CBCP 38,779 / 8,989 LM

ELLIPTICAL 42° x 10° (ELLB)

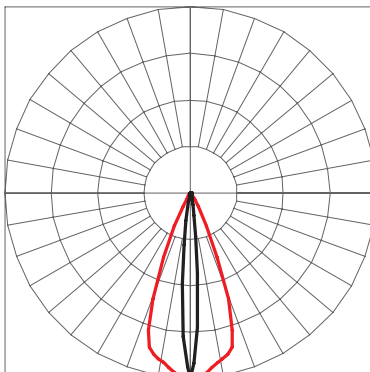

CBCP 69,772 / 10,460 LM

WIDE 39° x 20° (ELWB)

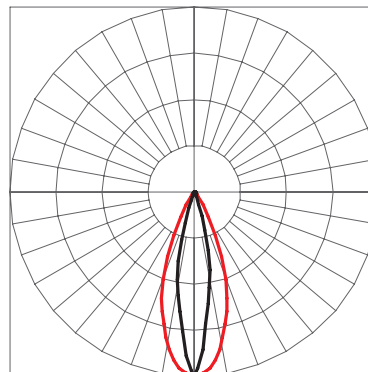

CBCP 34,424 / 9,815 LM

ACCESSORY DIMENSIONS

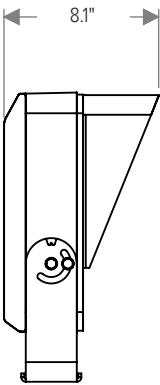

With Visor (CP300-VISOR-XX)

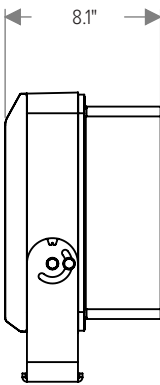

With Snoot (CP300-SNOOT-XX)

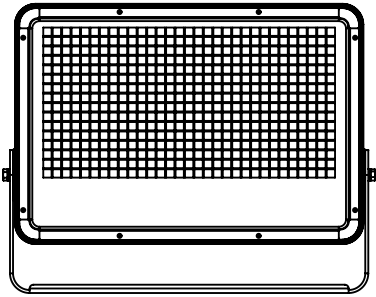
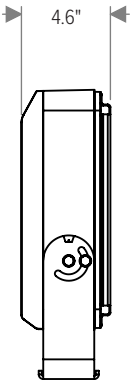

With Wire Guard (CP300-WIREGUARD-XX)

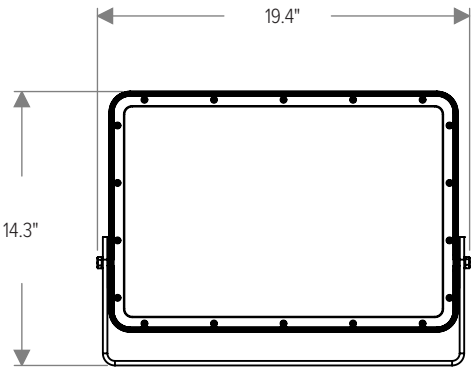

With 3G Mounting Yoke
(Factory Installed, Ordered with Luminaire)

ACCESSORIES

NOTE: Accessories are ordered and shipped separately from luminaire for field installation.
-XX* indicates a painted accessory. See bottom of page for painted accessory ordering information.



IR-CONFIG-REMOTE
Infrared Configuration Remote

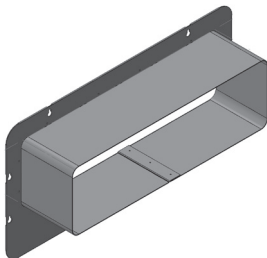

CP300-SNOOT-XX*
Snoot

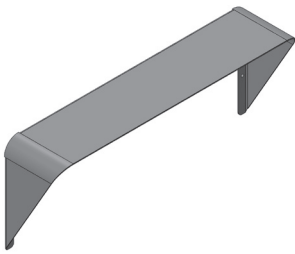

CP300-VISOR-XX*
Visor

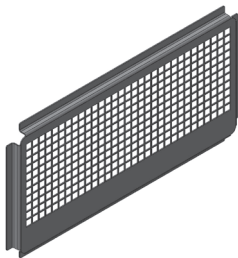

CP300-WIREGUARD-XX*
Wire Guard

ORDERING INFORMATION

PAINTED ACCESSORIES					
MODEL		FINISH (*-XX)		OPTION	
CP300-SNOOT	Snoot	AG	Anthracite Grey	AST	Anti-Saline Treatment
CP300-VISOR	Visor	BL	Black		
CP300-WIREGUARD	Wire Guard	SG	Griven Silver Grey		
		WH	White		
		CC	Custom RAL Color		

CONNECTIONS

"S" Type Cable (Power In, DMX In, DMX Out)

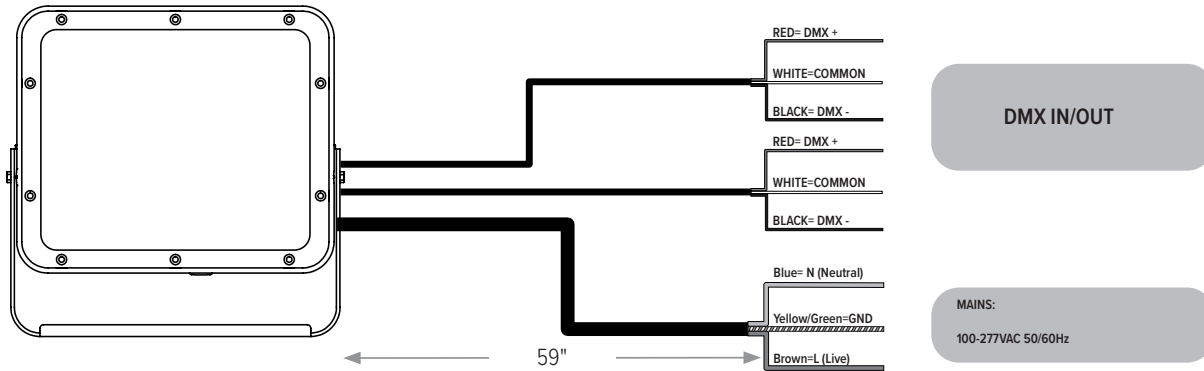

"M" Type Cable (Monocable Without Connectors)

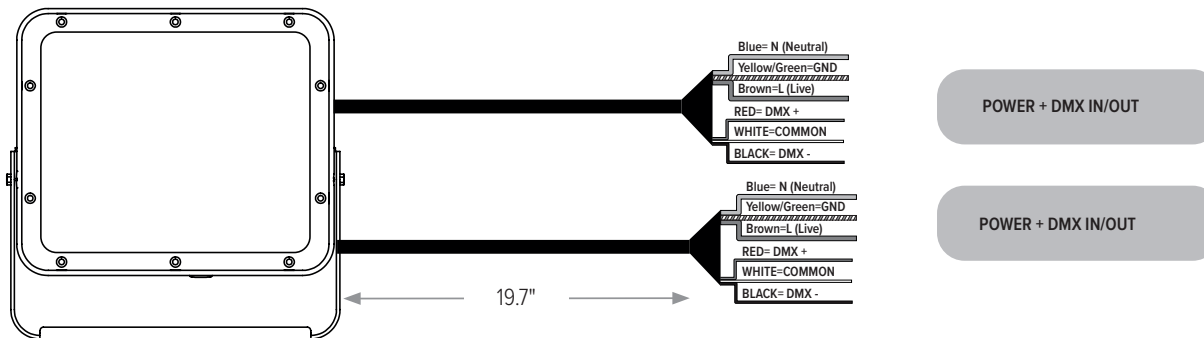

"C" Type Cable (Monocable With Connectors)

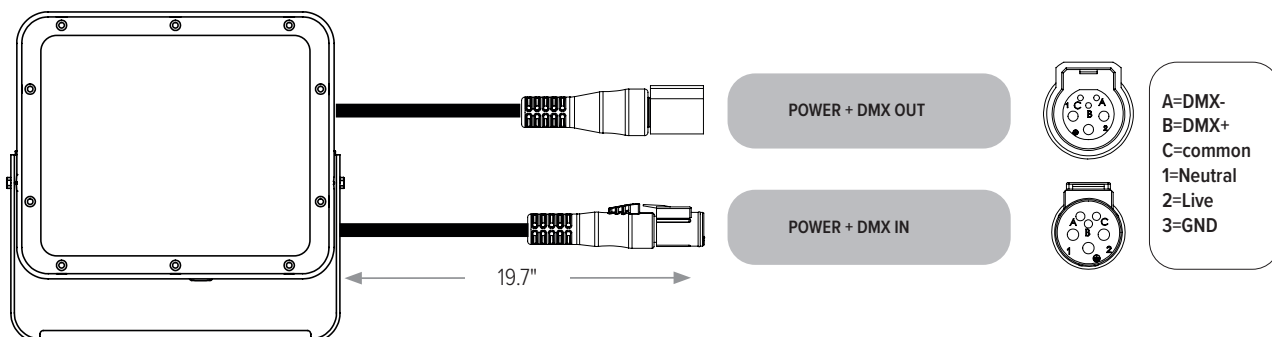

Note: the power and signal connections of S and M cable types can be carried out by using the connection kit included in the packing box. Follow the instructions provided along with the connection kit.

OPERATING MODES

DMX Mode

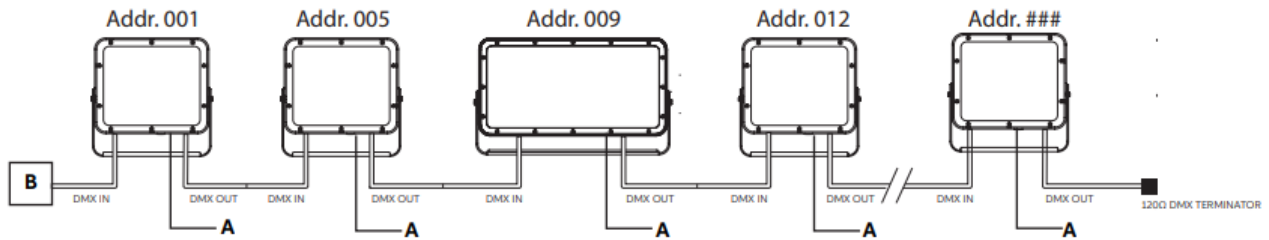

Example with fixtures set to 4 DMX channels

Master-Satellite/Automatic/Fixed Color Mode

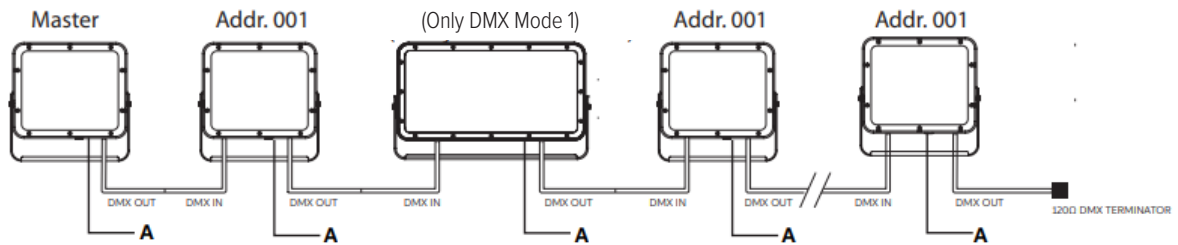

WARNING ! in this mode, no DMX control device must be present along the line.

CUSTOMIZE YOUR **EX**PERIENCE.

At Experience Brands, we believe every space deserves unique lighting elements. We proudly specialize in crafting solutions that reflect your personal vision. Our expert team is here to collaborate with you to design and implement customized features that elevate your environment.

Ready to Get Started? Email us at: DesignServices@exp-brands.com