

DESCRIPTION

PARADE L MC is an alternative multichip LED configuration that uses quad-color LEDs for illuminating large-scale facades or buildings. It offers unparalleled optical lenses and delivers seamless light distribution and smooth color transitioning. Parade L MC offers a comprehensive selection of optical configurations and four finish choices.

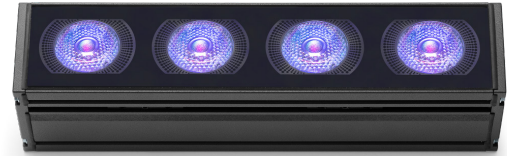

Date: _____ Type: _____ Catalog Number: _____

Project Name: _____

ORDERING INFORMATION

LUMINAIRE							
MODEL	CCT	CONTROL	CABLE	VOLTAGE	OPTIC*	FINISH	OPTION
PDL1MC Parade L 1 MC	RGBW30K RGBW + 3000K White	DMX-RDM DMX-RDM	C Monocable with Connectors (19.7 in.)	UNV 120 - 277V	SP Spot 9°	AG Anthracite Grey	MG Marine Grade
PDL2MC Parade L 2 MC	RGBW40K RGBW + 4000K White		M Monocable without Connectors (19.7 in.)		NB Narrow 14°	BL Black	
PDL3MC Parade L 3 MC					MB Medium 25°	SG Griven Silver Grey	
PDL4MC Parade L 4 MC					WB Wide 37°	WH White	
PDL1MCPE Parade L 1 MC					ELH Elliptical 51°x9°	CC Custom RAL Color	
PDL2MCPE Parade L 2 MC					ELWH Elliptical Wide 60°x33°		
PDL3MCPE Parade L 3 MC							*Contact Factory for Per Foot Resolution
PDL4MCPE Parade L 4 MC							

MOUNTING (Required)	MOUNTING ACCESSORIES	*XX- MOUNTING FINISHES	WIRING ACCESSORIES
AL5055 (2) 3" Bracket	WB-06-PDL1/L2-XX* (1) 6" Wall Bracket	AG Anthracite Grey	See separate Wiring and Accessory Application Sheet.
AL5056 (2) 6" Bracket	WB-06-PDL3/L4-XX* (2) 6" Wall Bracket	BL Black	
AL5057 (2) 10" Bracket		SG Griven Silver Grey	
		WH White	
		CC Custom RAL Color	

		PARADE L MC
PHYSICAL	HOUSING	Extruded aluminum body
	OVERALL DIMENSIONS	2.99"h x 12.57"w x 2.75"d
	WEIGHT	3.97 lbs
	OPERATING TEMPERATURE	-40°C to 50°C (-40°F to 122°F)

ELECTRICAL	POWER CONSUMPTION	20 watts max		
	AMPERAGE	0.2 A @ 120VAC 0.1 A @ 277VAC		
	CONTROL	DMX-RDM, Self-Addressing		
	MODES	- RGBW (4 channels)	- 16-Bit Mode (8 channels)	- Master Satellite Mode
		- RGBW + Intensity (5 channels)	- RGBW Calibrated White (4 channels)	
	- RGBW + Intensity + Strobe (6 channels) - Fixed Color			
	CABLE LENGTH	19.68"		

LIGHT DISTRIBUTIONS	DISTRIBUTION	BEAM ANGLE	LUMENS RGBW+3000K	MAX CANDELA RGBW+3000K	LUMENS RGBW+4000K	MAX CANDELA RGBW+4000K
		SPOT	9°	862		980
	NARROW	14°	803		913	39575.063
	MEDIUM	25°	784		891	14176.096
	WIDE	37°	596		678	3308.052
	ELLIPTICAL	51°x9°	783		889	19311.206
	ELLIPTICAL WIDE	60°x33°	768		873	5008.927

Values based on full output

PHOTOMETRIC	LED	RGBW+ (3000K or 4000K)				
	# LEDS	4 LEDS				
	DELIVERED LUMEN OUTPUT	980 lumens				
	EFFICACY	Up to 49 lumens per watt				
	LUMEN MAINTENANCE	L70>50000hrs				
	# DISTRIBUTIONS	6				
	LIGHT CONTROL ACCESSORIES	Visor, Snoot, Configuration Remote, Fixing Brackets, Line End Cap, DMX Terminator				

CERTIFICATIONS	SAFETY	ETL Certified for Wet Locations				
	INGRESS PROTECTION	IP67				
	IMPACT RATING	IK09				

PARADE L MC

RGBW



DIMENSIONS

All dimensions are shown in inches unless otherwise noted.

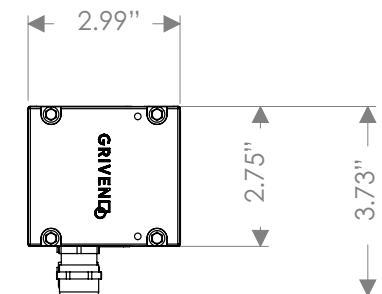
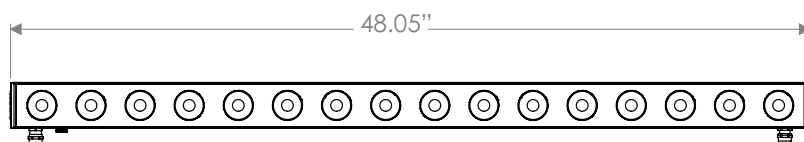
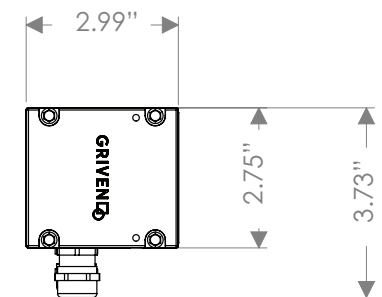
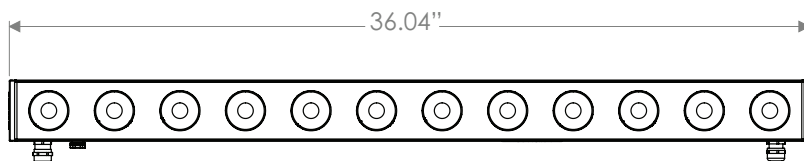
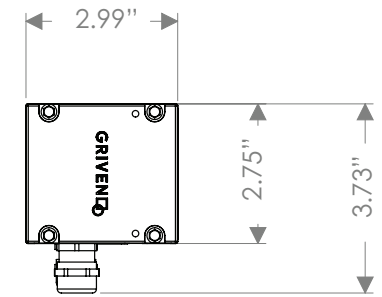
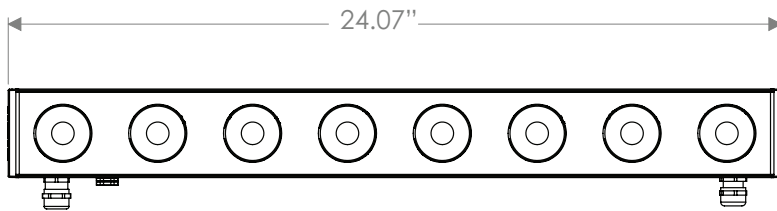
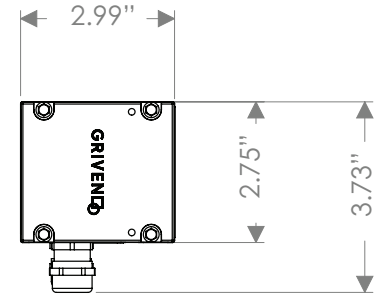
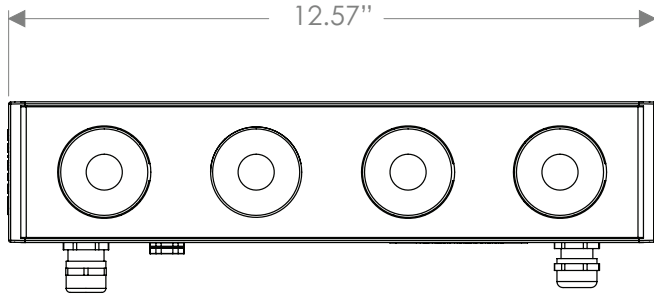

PHOTOMETRICS - RGBW CANDELA DISTRIBUTION

SPOT 9°

CBCP 67842.227 @ 980 lumens

Horizontal
Vertical

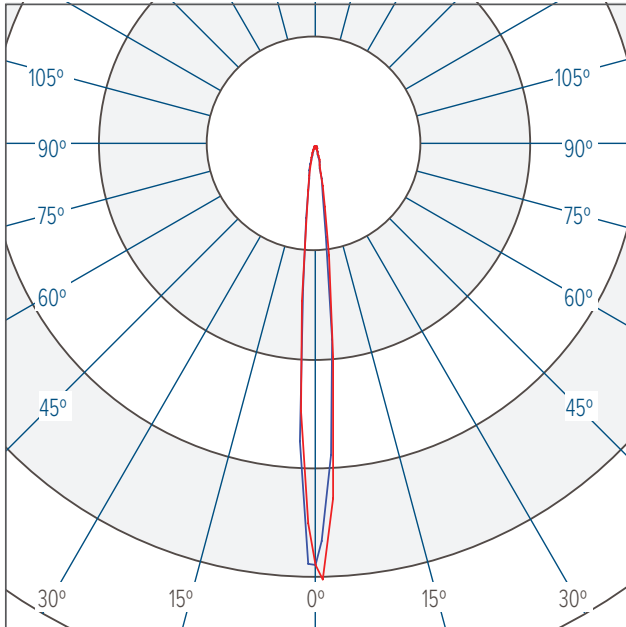

NARROW 14°

CBCP 39575.063 @ 913 lumens

Horizontal
Vertical

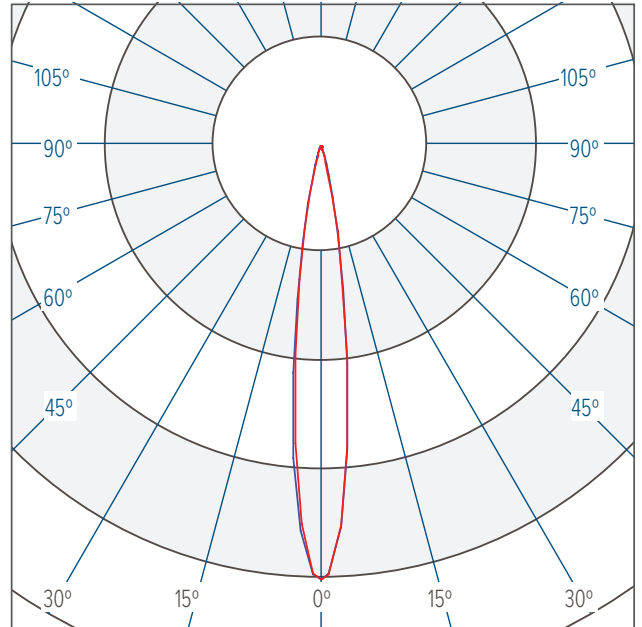

MEDIUM 25°

CBCP 14176.096 @ 891 lumens

Horizontal
Vertical

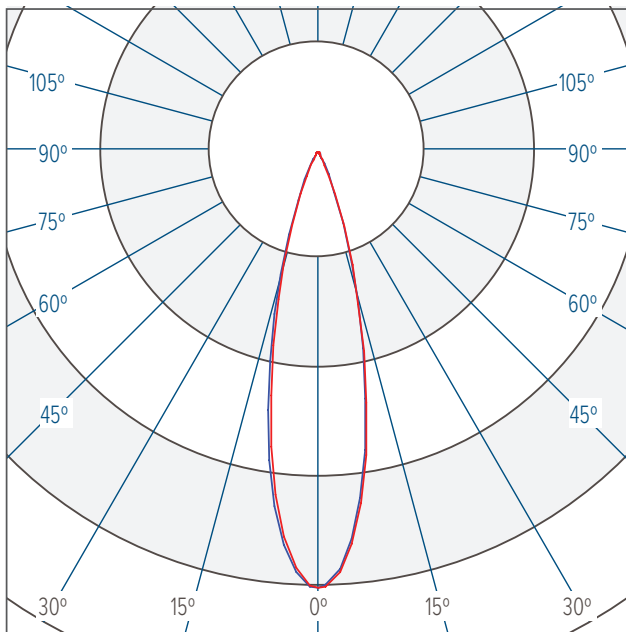

WIDE 37°

CBCP 3308.052 @ 678 lumens

Horizontal
Vertical

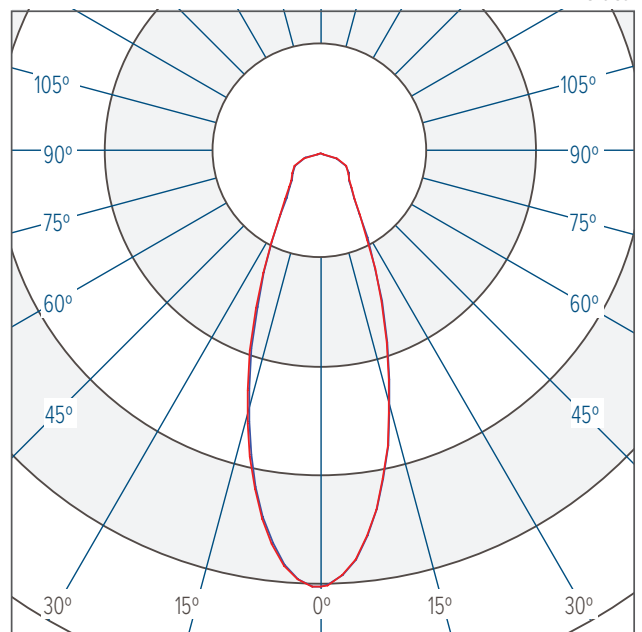

PHOTOMETRICS - STATIC WHITE CANDELA DISTRIBUTION

ELLIPTICAL 51°x9°

CBCP 19311.206 @ 889 lumens

— Horizontal
— Vertical

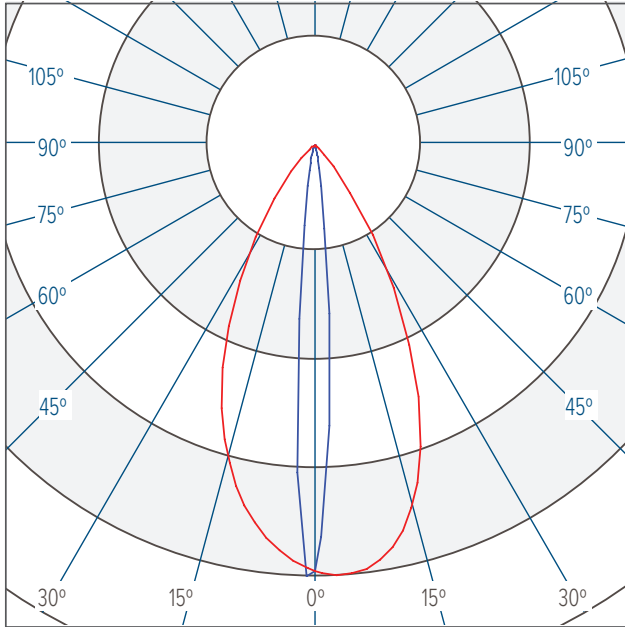

ELLIPTICAL WIDE 60°x33°

CBCP 5008.927 @ 873 lumens

— Horizontal
— Vertical

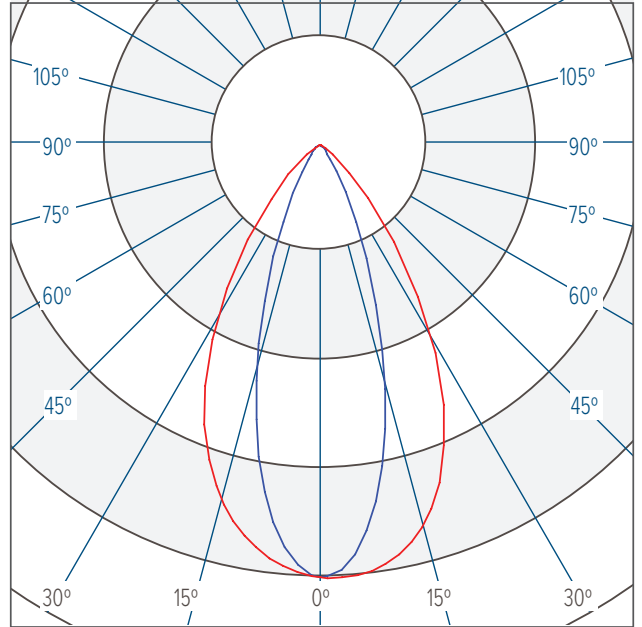

ACCESSORIES

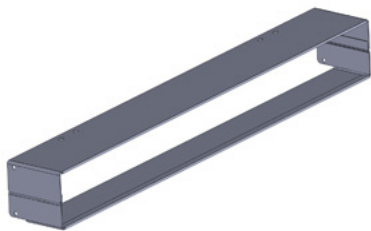

Snoot (Specify Finish)

- AL5103-XX* *Snoot for Parade PDL1*
- AL5104-XX* *Snoot for Parade PDL2*
- AL5105-XX* *Snoot for Parade PDL3*
- AL5106-XX* *Snoot for Parade PDL4*

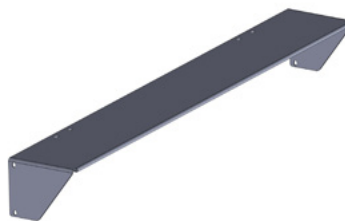

Visor (Specify Finish)

- AL5096-XX* *Visor for Parade PDL1*
- AL5097-XX* *Visor for Parade PDL2*
- AL5098-XX* *Visor for Parade PDL3*
- AL5099-XX* *Visor for Parade PDL4*

***XX- ACCESSORY FINISHES**

- AG Anthracite Grey
- BL Black
- SG Griven Silver Grey
- WH White
- CC Custom RAL Color



Infrared Remote Control (Note: Unless an RDM compatible control is used, an Infrared Remote Control (AL1321) must be purchased in order to access DMX addressing.)

AL1321

LUMINAIRE BRACKET OPTIONS (sold separately)

All dimensions are shown in inches unless otherwise noted.

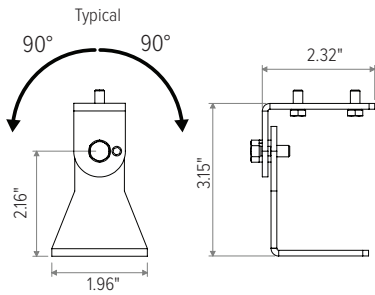

AL5055

3.15" Bracket

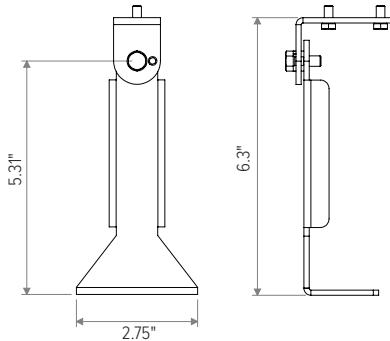

AL5056

6.3" Bracket

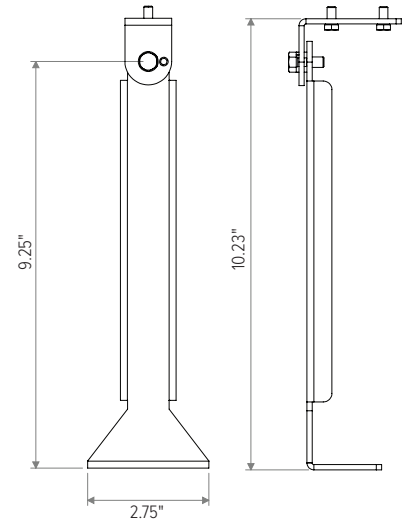

AL5057

10.23" Bracket

WALL BRACKET OPTIONS (sold separately)

The Griven Parade L MC Wall Bracket can be used with the Griven Parade L MC product family. The Wall Bracket will position the center of the Parade L MC optics at a distance of six inches from the wall.

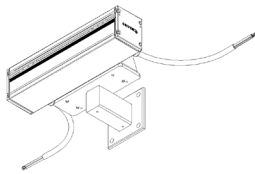

WB-06-PDL1/L2-XX* (*Specify finish)

(1) 6" Wall Bracket

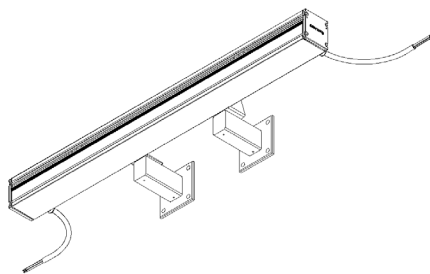
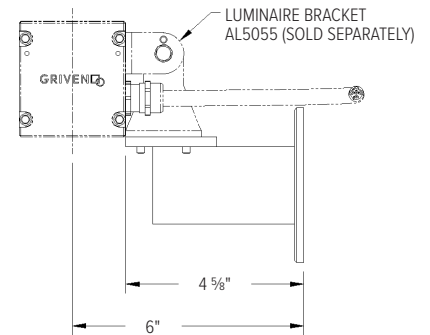
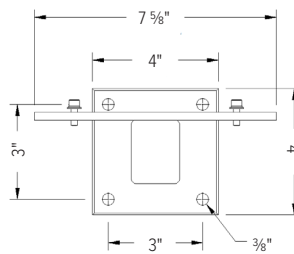

WB-06-PDL3/L4-XX* (*Specify finish)

(2) 6" Wall Bracket

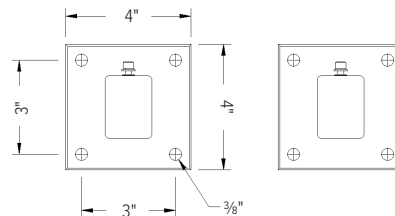

PARADE L3
9-5/8" MIN - 26-3/4" MAX
PARADE L4
15-5/8" MIN - 38-7/8" MAX

