

## DESCRIPTION

PARADE L MC linear luminaires are available in one, two, three, or four foot lengths. Each model features premium quality high-brightness multi-chip LEDs and a comprehensive selection of six light distributions. Standard built-in programming capabilities include standalone or master-satellite configurations without the use of external control systems, or operation by remote DMX512 control systems. All hardware is stainless steel.

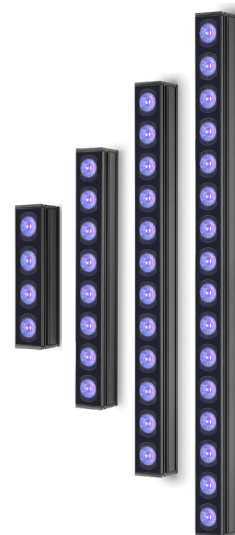

Date: \_\_\_\_\_ Type: \_\_\_\_\_ Catalog Number: \_\_\_\_\_

Project Name: \_\_\_\_\_

## ORDERING INFORMATION

LUMINAIRE							
MODEL	CCT	CONTROL	CABLE	VOLTAGE	OPTIC	FINISH	OPTION
<b>PDL1MC</b> Parade L1 MC- 1' Length	<b>RGBW30K</b> RGBW (3000K White)	<b>DMX-RDM</b> DMX-RDM	<b>M</b> Monocable Without Connectors (19.7")	<b>UNV</b> 120-277v	<b>SP</b> Spot 9°	<b>AG</b> Anthracite Grey	<b>AST</b> Anti-Saline Treatment
<b>PDL2MC</b> Parade L2 MC- 2' Length	<b>RGBW40K</b> RGBW (4000K White)		<b>C</b> Monocable With Connectors (19.7")		<b>NB</b> Narrow 14°	<b>BL</b> Black	
<b>PDL3MC</b> Parade L3 MC- 3' Length					<b>MB</b> Medium 25°	<b>SG</b> Griven Silver Grey	
<b>PDL4MC</b> Parade L4 MC- 4' Length					<b>WB</b> Wide 37°	<b>WH</b> White	
<b>PDL1MCPE</b> Parade L1 MC Polar Edition- 1' Length					<b>ELH</b> Elliptical 50° x 9°	<b>CC</b> Custom RAL Color	
<b>PDL2MCPE</b> Parade L2 MC Polar Edition- 2' Length					<b>ELWH</b> Elliptical Wide 60° x 33°		
<b>PDL3MCPE</b> Parade L3 MC Polar Edition- 3' Length							
<b>PDL4MCPE</b> Parade L4 MC Polar Edition- 4' Length							

Custom options are available; consult factory for assistance via phone at (864) 487-3535 ext. 258 or via email at DesignServices@EXP-Brands.com.

See Page 4 for ordering information of available and required accessories.



		PARADE L1 MC	PARADE L2 MC	PARADE L3 MC	PARADE L4 MC
PHYSICAL	HOUSING	Extruded Aluminum			
	DIMENSIONS	12.5" L x 2.8" W x 3" H	24.1" L x 2.8" W x 3" H	36" L x 2.8" W x 3" H	48.1" L x 2.8" W x 3" H
	WEIGHT	4.6 Pounds	6.8 Pounds	9.7 Pounds	12.3 Pounds
	OPERATING TEMPERATURE	-40°F to 122°F (-40°C to 50°C)			

ELECTRICAL	POWER CONSUMPTION	20 Watts	37 Watts	55 Watts	74 Watts
	AMPERAGE	0.17A @ 120V 0.07A @ 277V	0.31A @ 120V 0.13A @ 277V	0.46A @ 120V 0.20A @ 277V	0.61A @ 120V 0.26A @ 277V
	CONTROL PROTOCOLS *	DMX/RDM   Self-Addressing   Standalone   Master-Satellite   DMX/RDM Addressable per foot (Contact Factory) * See separate DMX Mode Application Sheet			
	CABLE LENGTH	19.7"			
	CONNECTION KIT	GRIVEN-CON-KIT-8287 for "M" Cable			

PHOTOMETRIC	LED	RGBW (3000K or 4000K White) Multi-Chip			
	NUMBER OF LEDS	4	8	12	16
	L70 LUMEN MAINTENANCE	> 50,000 Hours			
	# DISTRIBUTIONS	Six			

LIGHT DISTRIBUTIONS*	DISTRIBUTION	BEAM ANGLE	RGBW 3000K			RGBW 4000K		
			LUMENS	EFFICACY	MAX. CANDELA	LUMENS	EFFICACY	MAX. CANDELA
			PARADE L1 MC					
	SPOT	9°	862	43	16258	980	49	18484
	NARROW	14°	803	40	9418	913	46	10708
	MEDIUM	25°	784	39	3374	891	45	3835
	WIDE	37°	596	30	786	678	34	895
	ELLIPTICAL	50° x 9°	801	40	8581	889	44	5268
	ELLIPTICAL WIDE	60° x 33°	768	38	1192	873	44	1355
	PARADE L2 MC							
	SPOT	9°	1595	43	30083	1814	49	34206
	NARROW	14°	1486	40	17428	1689	46	19803
	MEDIUM	25°	1450	39	6241	1648	45	7092
	WIDE	37°	1103	30	1455	1254	34	1654
	ELLIPTICAL	50° x 9°	1488	40	8818	1645	44	9749
	ELLIPTICAL WIDE	60° x 33°	1421	38	2206	1615	44	2507
	PARADE L3 MC							
	SPOT	9°	2372	43	44731	2695	49	50823
	NARROW	14°	2209	40	25907	2510	46	29437
	MEDIUM	25°	2156	39	9279	2450	45	10545
	WIDE	37°	1640	30	2164	1864	34	2459
	ELLIPTICAL	50° x 9°	2152	39	12753	2445	44	14490
	ELLIPTICAL WIDE	60° x 33°	2112	38	3279	2401	44	3728
	PARADE L4 MC							
	SPOT	9°	3190	43	60167	3626	49	68382
	NARROW	14°	2972	40	34856	3377	46	39605
	MEDIUM	25°	2900	39	12482	3296	45	14186
	WIDE	37°	2207	30	2912	2508	34	3309
	ELLIPTICAL	50° x 9°	2895	39	17156	3290	44	19497
	ELLIPTICAL WIDE	60° x 33°	2842	38	4412	3230	44	5015

\* Values based on full RGBW output.

CERTIFICATIONS	SAFETY	ETL Listed for Wet Locations
	INGRESS PROTECTION	IP67
	IMPACT RATING	IK09
	WARRANTY	Five Year Limited Warranty

DIMENSIONS

All dimensions are shown in inches unless otherwise noted.

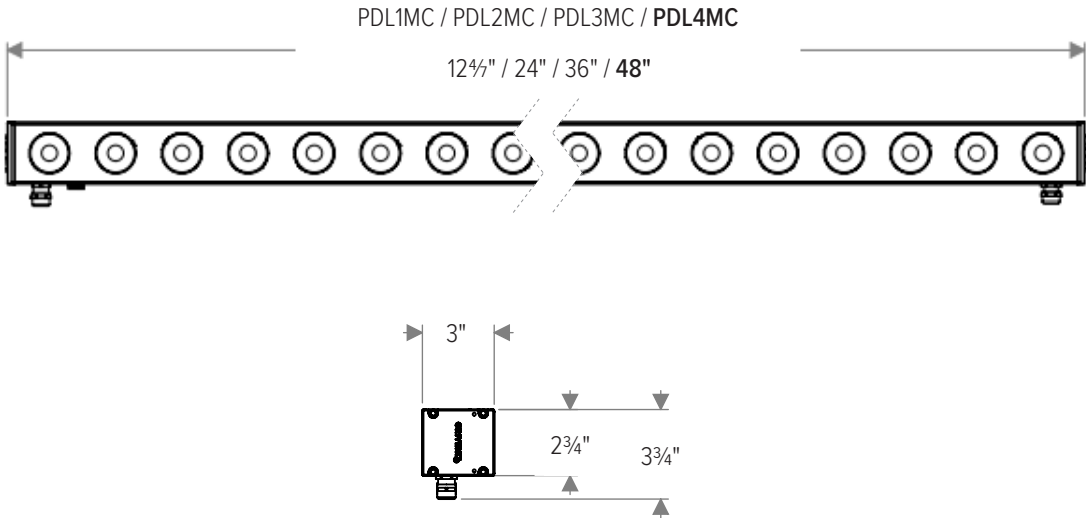

CUSTOMIZE YOUR **EXPERIENCE.**

At Experience Brands, we believe every space deserves unique lighting elements. We proudly specialize in crafting solutions that reflect your personal vision. Our expert team is here to collaborate with you to design and implement customized features that elevate your environment.

**Ready to Get Started?** Email us at: [DesignServices@exp-brands.com](mailto:DesignServices@exp-brands.com)

ACCESSORIES

NOTE: Accessories are ordered and shipped separately from luminaire for field installation.



**IR-CONFIG-REMOTE**  
Infrared DMX Configuration Remote

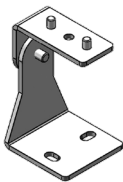

**PDL-BRKT-3IN**  
3" Mounting Brackets (2)

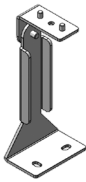

**PDL-BRKT-6IN**  
6" Mounting Brackets (2)

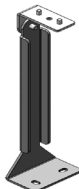

**PDL-BRKT-10IN**  
10" Mounting Brackets (2)

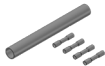

**GRIVEN-CON-KIT-8287**  
Connection Kit for "M" Cable Type



Visor



Snoot

Additional Control and Installation Solutions are available online; click here to view available options.

ORDERING INFORMATION

PAINTED ACCESSORIES			
MODEL	ACCESSORY	FINISH	OPTION
<b>PDL1MC</b> Parade L1	<b>VISOR</b> Louver	<b>AG</b> Anthracite Grey	<b>AST</b> Anti-Saline Treatment
<b>PDL2MC</b> Parade L2	<b>SNOOT</b> Snoot	<b>BL</b> Black	
<b>PDL3MC</b> Parade L3		<b>SG</b> Griven Silver Grey	
<b>PDL4MC</b> Parade L4		<b>WH</b> White	
		<b>CC</b> Custom RAL Color	

ORDERING INFORMATION

UNPAINTED ACCESSORIES	
MODEL	
<b>IR-CONFIG-REMOTE</b> Infrared DMX Configuration Remote <sup>1</sup>	
<b>PDL-BRKT-3IN</b> Parade Mounting Brackets, Set of 2, 3" Height	
<b>PDL-BRKT-6IN</b> Parade Mounting Brackets, Set of 2, 6" Height	
<b>PDL-BRKT-10IN</b> Parade Mounting Brackets, Set of 2, 10" Height	
<b>GRIVEN-CON-KIT-8287</b> Connection Kit for "M" Cable	

<sup>1</sup>Unless an RDM compatible control is used, one IR-CONFIG-REMOTE must always be purchased with one or more DMX/RDM luminaires in order to access DMX addressing.

## MOUNTING

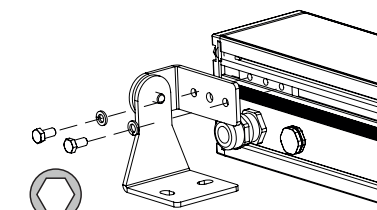

Size 8 (ISO)  
socketed Hex key

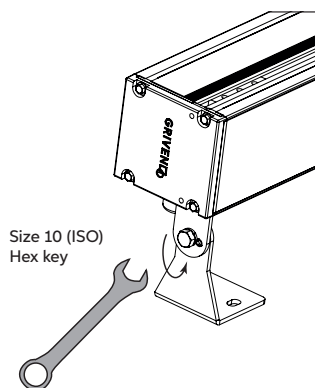
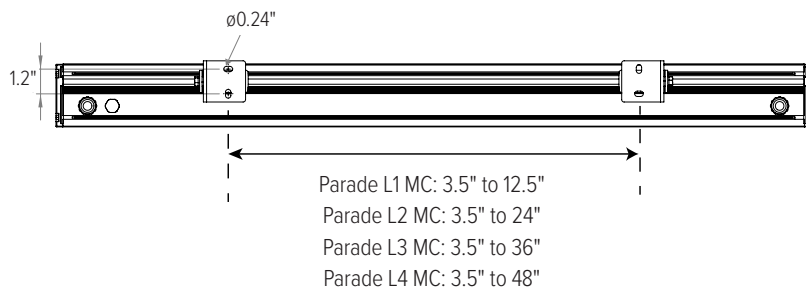

Size 10 (ISO)  
Hex key

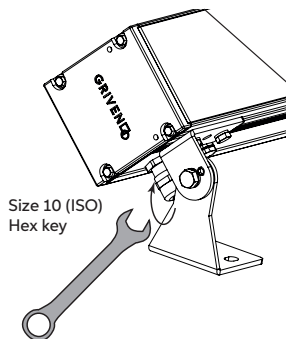
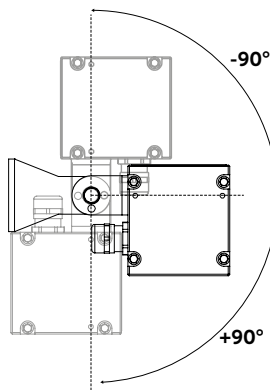

Size 10 (ISO)  
Hex key

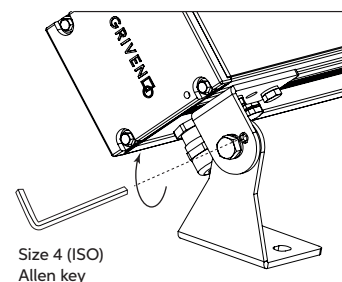

Size 4 (ISO)  
Allen key

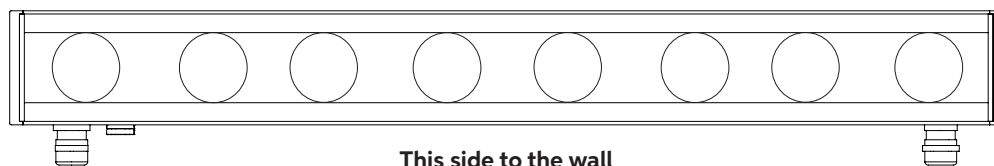

For 3G applications, use the following to determine mounting locations:

Parade L1 MC: A = 3.2" | B = 3.2"

Parade L2 MC: A = 5.9" | B = 5.9"

Parade L3 MC: A = 8.9" | B = 8.9"

Parade L4 MC: A = 11.8" | B = 11.8"



PHOTOMETRICS

Note: Values shown are for Parade L4 MC in RGBW 4000K. See Prorate Table on page 6 to determine photometric and lumen values of other formats.

SPOT 9°

CBCP 68382 @ 3626 lumens

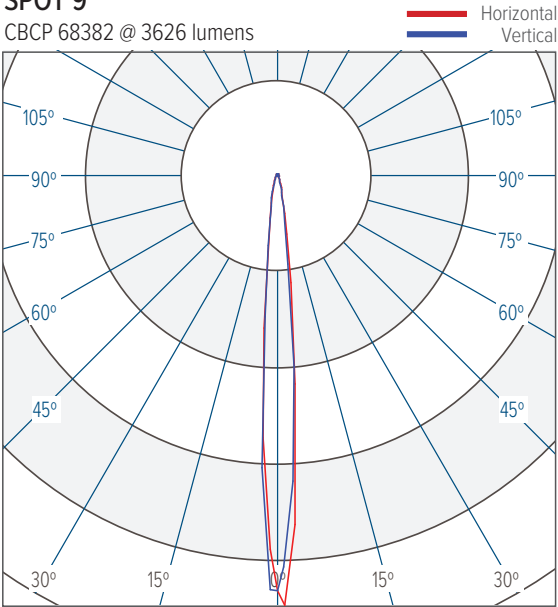

NARROW 14°

CBCP 39605 @ 3377 lumens

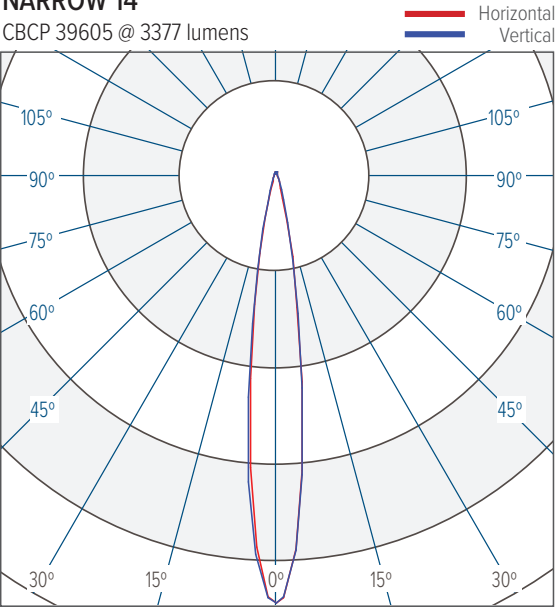

MEDIUM 25°

CBCP 14186 @ 3296 lumens

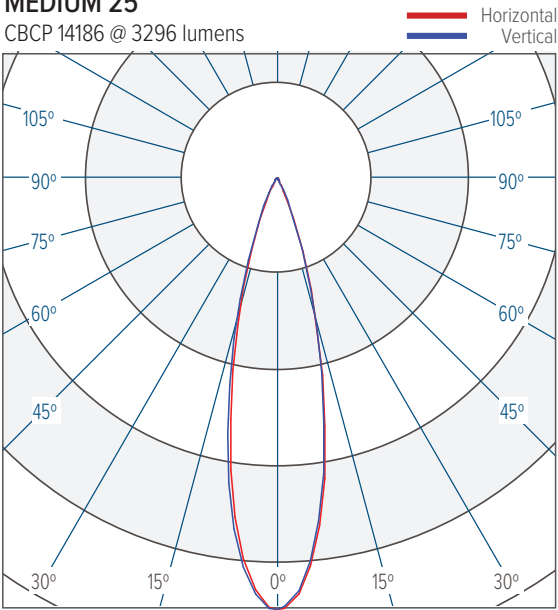

WIDE 37°

CBCP 3309 @ 2508 lumens

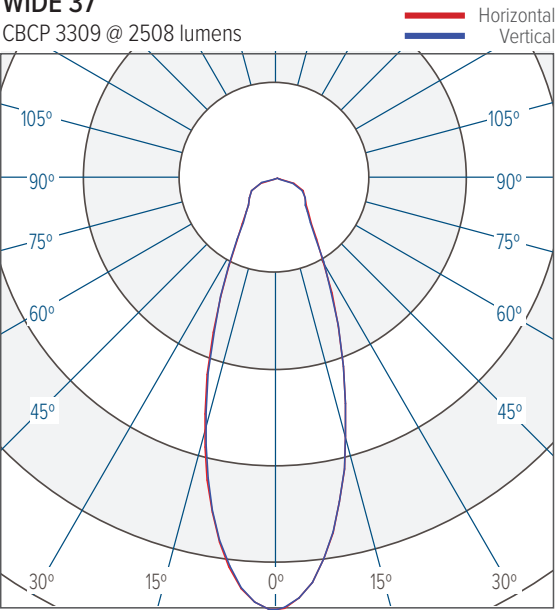

PHOTOMETRICS

Note: Values shown are for Parade L4 MC in RGBW 4000K. See Prorate Table on page 6 to determine photometric and lumen values of other formats.

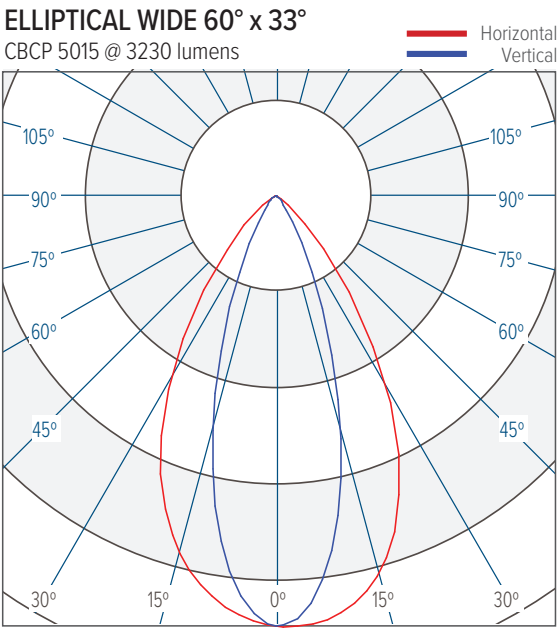
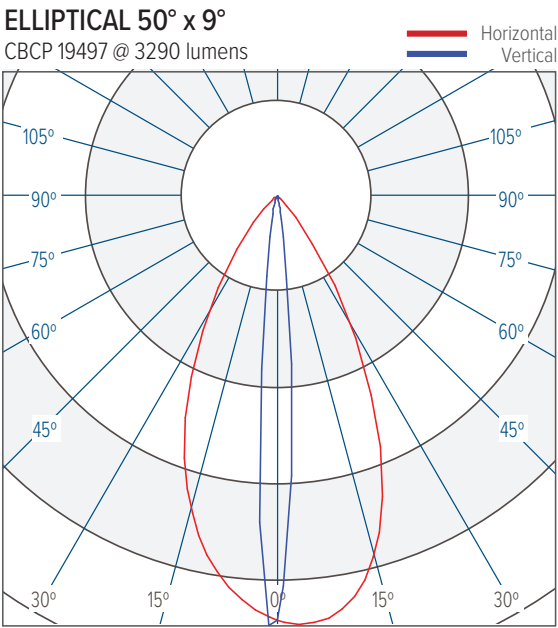

PHOTOMETRIC PRORATE FACTORS		
	RGBW 3000K	RGBW 4000K
Parade L1 MC	0.24	0.27
Parade L2 MC	0.44	0.50
Parade L3 MC	0.65	0.74
Parade L4 MC	0.88	1.0

CONNECTIONS

"C" Type Cable (Monocable With Connectors)

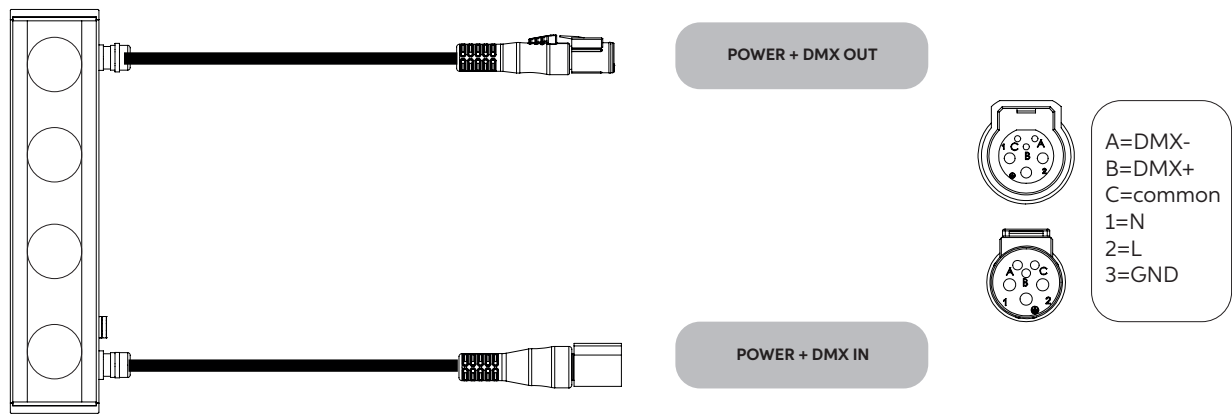

"M" Type Cable (Monocable Without Connectors)

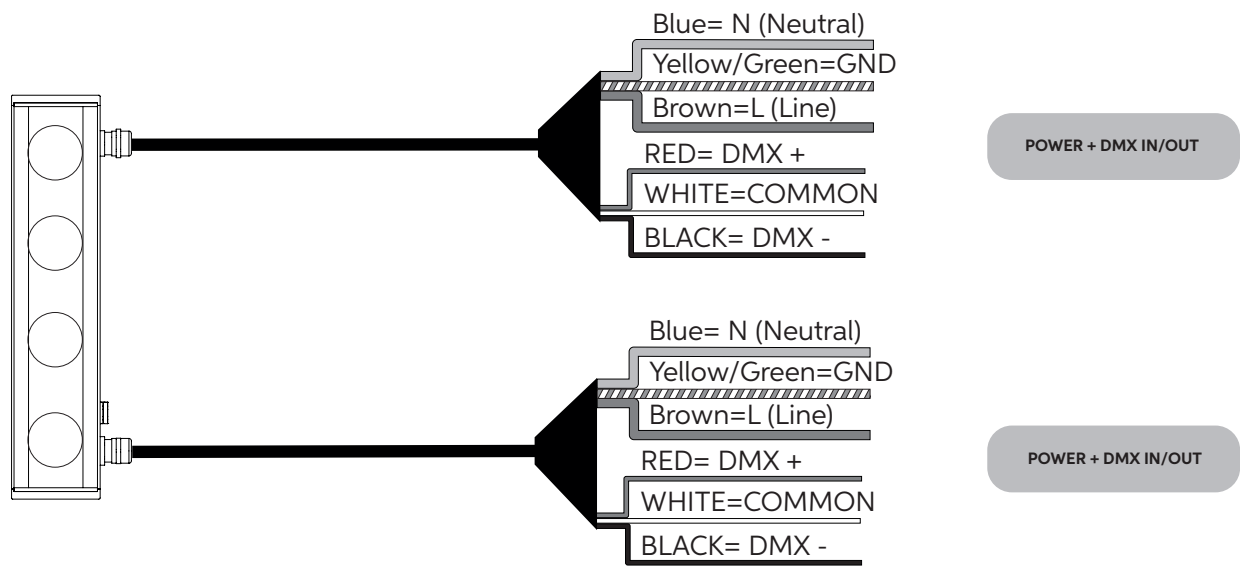



OPERATING MODES

DMX Mode

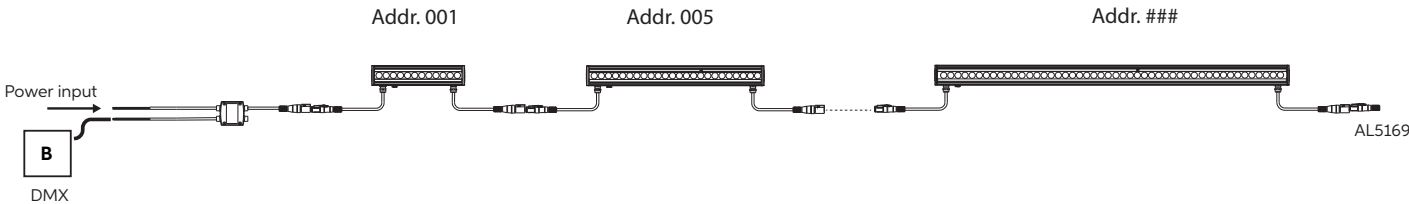

Example with fixtures set at 4 DMX channels

Master-Satellite/Automatic/Fixed Color Mode

( Only DMX Mode #1 )

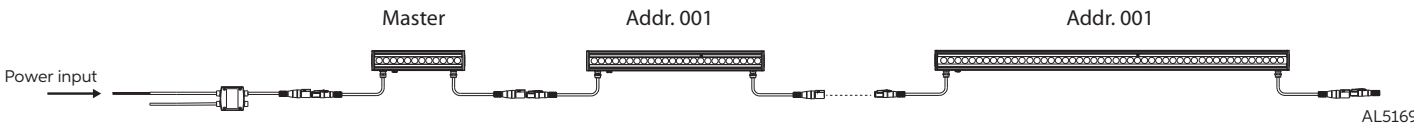

CONFIGURATION

Single Chain Configuration

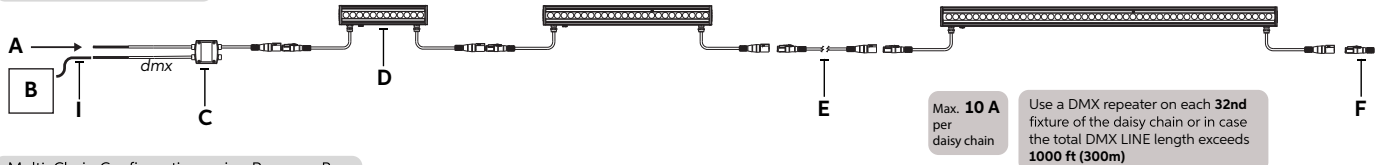

Multi Chain Configuration using Repower Box

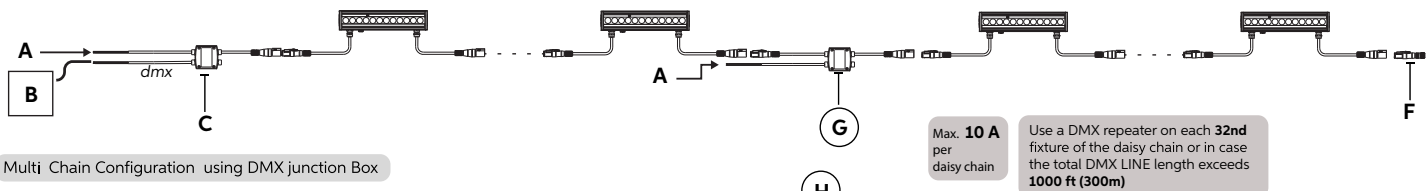

Multi Chain Configuration using DMX junction Box

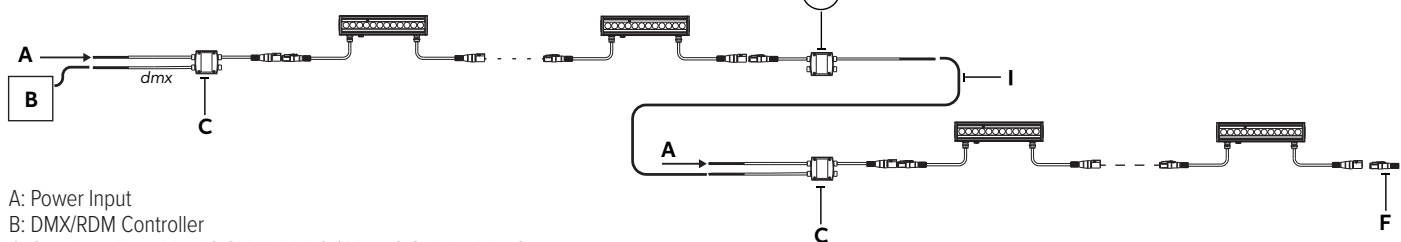

- A: Power Input  
B: DMX/RDM Controller  
C: Start Line Box- *PDLMC-STRTLNBX-C / PDLMC-STRTLNBX-NC*  
D: Parade L1, L2, L3, L4 MC or L2 MC or L3 MC Recessed  
E: Connection Cable- *PDLMC-CBL-1M, PDLMC-CBL-2M, PDLMC-CBL-3M, PDLMC-CBL-5M, PDLMC-CBL-10M*  
F: DMX Terminator- *PDLMC-DMXTRMNT*  
G: Repower Box- *PDLMC-RPWRBX-C / PDLMC-RPWRBX-NC*  
H: DMX Junction Box- *PDLMC-DMXJB-C / PDLMC-DMXJB-NC*  
I: DMX Cable

CE Colours	USE
Brown	Live
Blue	Neutral
Yellow/Green	Ground
Red	DMX Data +
Black	DMX Data -
White	DMX GND