

DESCRIPTION

PARADE L RGBW is a versatile family of linear projectors featuring industry leading output for truly impressive wall grazing on a wide range of architectural elements. Available in one-foot increments from one to four feet overall, each model features premium quality high brightness RGBW LEDs with 4000K natural white to deliver the largest range of warm white shades and pastel tones. The luminaires offer a comprehensive selection of ten light distributions from symmetrical spot to extra wide beams to elliptical and wall wash distributions. Specialized optical treatments ensure uniform color coverage even on close-up installations. Adjustable brackets in a choice of three standard lengths allow luminaire installation with the desired projection or setback. The lightweight luminaire features an integral power supply within its narrow profile, eliminating the need for additional electrical hardware and further simplified through combined power and data wiring. Standard built-in programming capabilities include economical stand-alone operation or master-satellite configurations without the use of external control systems, or operation by remote DMX512 control systems. Four standard finishes are available with options for marine-grade or custom RAL finishes on request. All hardware is stainless steel.

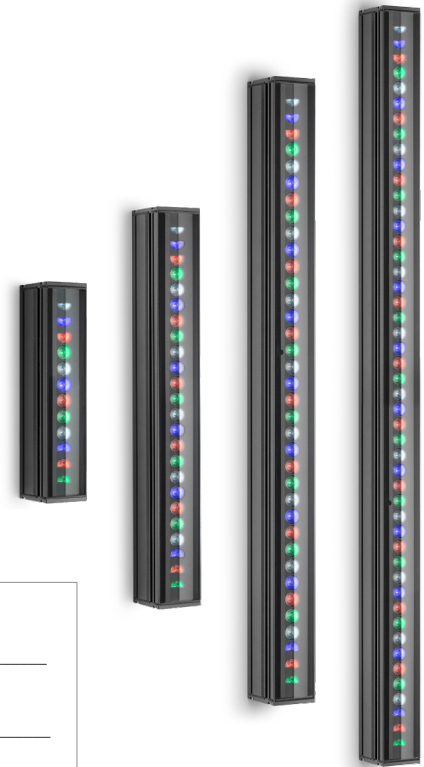

IP67 / IK09 / CE / ETL

Date: _____ Type: _____ Catalog Number: _____

Project Name: _____

ORDERING INFORMATION

LUMINAIRE						
MODEL	LED	VOLTAGE	OPTIC *		FINISH **	OPTIONS
PDL1 Parade L1 - 1' Length	RGBW RGBW (4000K White)	UNV 120-277V	SP Spot 8°	ELH Elliptical Horizontal 42° x 11°	AG Anthracite Gray (RAL7016)	LVR Honeycomb Louver (internal)
PDL2 Parade L2 - 2' Length			NB Narrow 12°	ELV Elliptical Vertical 11° x 42°	BL Black (RAL9005)	
PDL3 Parade L3 - 3' Length			MB Medium 26°	ELWH Elliptical Wide Horizontal 40° x 24°	SG Griven Silver Grey	
PDL4 Parade L4 - 4' Length			WB Wide 40°	ELWV Elliptical Wide Vertical 24° x 40°	WH White (RAL9003)	
			EW Extra Wide 58°	WW Wall Wash 36° x 15° (5° incline)	CC Custom Color (RAL Finish)	

* Contact factory for availability of optional factory installed spreading diffusers

** Contact factory for marine grade finishes

LUMINAIRE MOUNTING BRACKETS		WIRING & PROGRAMMING ACCESSORIES		LIGHT CONTROL ACCESSORIES	
AL5055	3" (80mm) Bracket Pair	GRV-JB-SL	Start Line J-Box	AL5096	Visor for Parade PDL1
AL5056	6" (160mm) Bracket Pair	GRV-JB-MCPDC	Continuation J-Box	AL5097	Visor for Parade PDL2
AL5057	10" (260mm) Bracket Pair	GRV-JB-MCEL	End Line J-Box	AL5098	Visor for Parade PDL3
		GRV-JB-MCDC	DMX Continuation Box	AL5099	Visor for Parade PDL4
		GRV-DMX-TERM	DMX Terminator	AL5103	Snoot for Parade PDL1
WB-06-PDL1/L2-xx*	(1) 6" (152mm) Wall Bracket	GRV-MC-xx**	Mono-cable (Power & DMX)	AL5104	Snoot for Parade PDL2
WB-06-PDL3/L4-xx*	(2) 6" (152mm) Wall Bracket	GRV-DMX-xx**	DMX Cable	AL5105	Snoot for Parade PDL3
		AL1321	Infrared Remote Control	AL5106	Snoot for Parade PDL4

*Specify finish

**Specify xx in feet

		PARADE L1	PARADE L2	PARADE L3	PARADE L4
PHYSICAL	HOUSING	Extruded aluminum			
	HOUSING SIZE	12-5/8" x 2-3/4" x 3"	24" x 2-3/4" x 3"	36" x 2-3/4" x 3"	48" x 2-3/4" x 3"
	YOKE	Fabricated aluminum			
	WEIGHT	4 lbs	6.2 lbs	9 lbs	11.7 lbs
	INGRESS PROTECTION	IP67			

PHOTOMETRIC	LED	RGBW (4000K White)			
	# LEDS	12	24	36	48
	L70 LUMEN MAINTENANCE	100,000 Hours @ 25°C*			
	# DISTRIBUTIONS	Ten			
	VERTICAL AIMING CAPABILITY	+/- 90°			
	LIGHT CONTROL ACCESSORIES	Visor, Snoot			
	LIGHT CONTROL ACCESSORIES	Consult factory for optional spreading diffusers			

LIGHT DISTRIBUTIONS	DISTRIBUTION	BEAM ANGLE	LUMENS / MAX CANDELA	LUMENS / MAX CANDELA	LUMENS / MAX CANDELA	LUMENS / MAX CANDELA
	SPOT	8°	722 / 17982	1643 / 40342	2538 / 63885	3468 / 80722
	NARROW	12°	694 / 8222	1579 / 18703	2440 / 28902	3334 / 39491
	MEDIUM	26°	696 / 2797	1584 / 6370	2447 / 9840	3343 / 13443
	WIDE	40°	626 / 1146	1425 / 2607	2201 / 9755	3007 / 5501
	EXTRA WIDE	58°	490 / 513	1115 / 1168	2102 / 5414	2354 / 2466
	ELLIPTICAL	42° x 11°	650 / 2926	1479 / 6660	2285 / 10289	3122 / 14058
	ELLIPTICAL VERTICAL	11° x 42°	650 / 2926	1479 / 6660	2285 / 10289	3122 / 14058
	ELLIPTICAL WIDE	40° X 24°	598 / 1540	1361 / 3505	1722 / 1804	2872 / 7397
	ELLIPTICAL WIDE VERTICAL	24° X 40°	598 / 1540	1361 / 3305	1722 / 1804	2872 / 7397
	WALL WASH (INCLINED 5°)	36° X 15°	628 / 2773	1429 / 6313	2208 / 9755	3016 / 13324

ELECTRICAL	POWER CONSUMPTION	20 watts max	38 watts max	59 watts max	79 watts max
	AMPERAGE	0.15A @ 120VAC 0.08A @ 277VAC	0.32A @ 120VAC 0.15A @ 277VAC	0.50A @ 120VAC 0.22A @ 277VAC	0.67A @ 120VAC 0.29A @ 277VAC
	EFFICACY	Up to 40.2 lumens per watt			
	LUMEN OUTPUT	490 to 722 lumens	1115 to 1643 lumens	1722 to 2538 lumens	2354 to 3468 lumens
	CONTROL PROTOCOLS	DMX-RDM / Standalone / Master-Satellite			
	OPERATING TEMPERATURE	-40°C to 50°C (-40°F to 122°F)			

CERTIFICATIONS	SAFETY	ETL Listed for Wet Locations			
	INGRESS PROTECTION	IP67			
	IMPACT RATING	IK09			
	EUROPEAN CE	CE			

ACCESSORIES	VISOR	x	x	x	x
	SNOOT	x	x	x	x
	HONEYCOMB LOUVER	x	x	x	x
	3" BRACKETS	x	x	x	x
	6" BRACKETS	x	x	x	x
	10" BRACKETS	x	x	x	x
	INFRARED REMOTE CONTROL	x	x	x	x

DIMENSIONS All dimensions are shown in inches unless otherwise noted.

PDL1

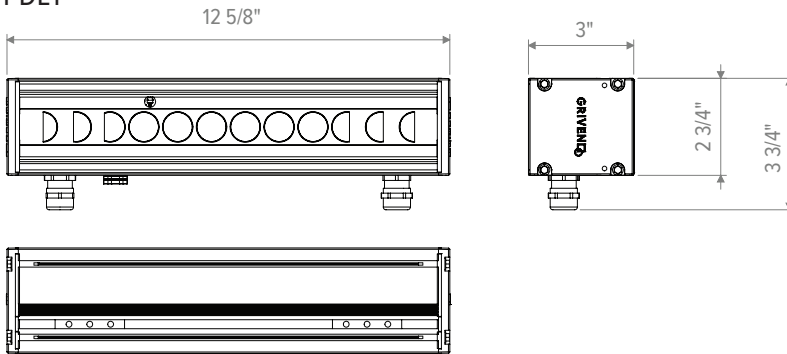

PDL2

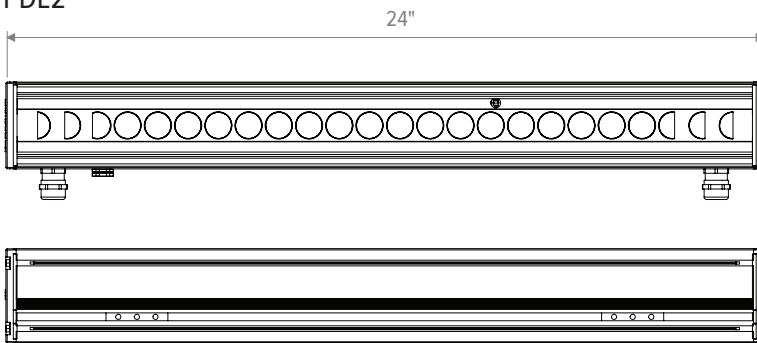

PDL3

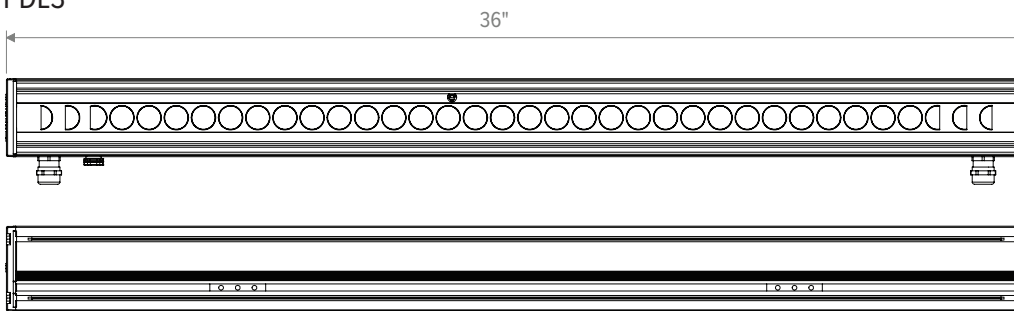

PDL4

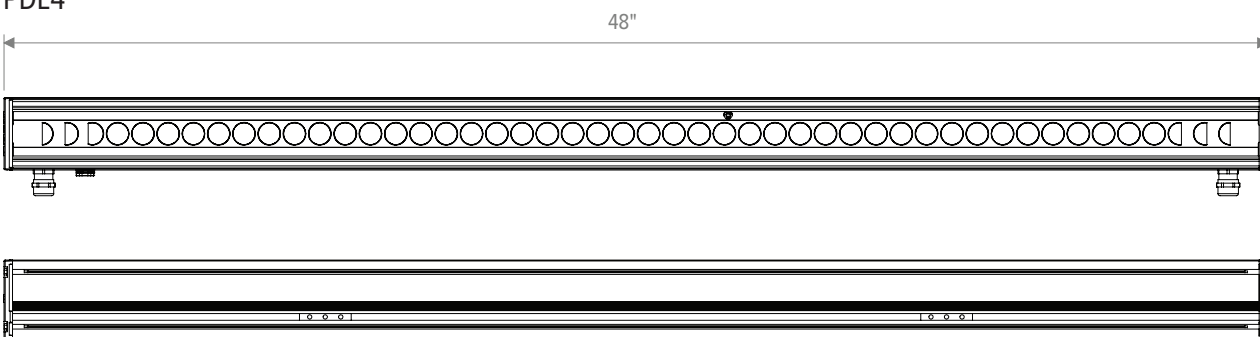

LUMINAIRE BRACKET OPTIONS (sold separately)

All dimensions are shown in inches unless otherwise noted.

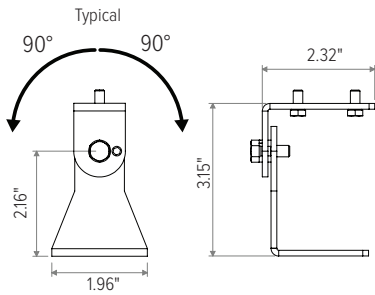

AL5055

3.15" Bracket

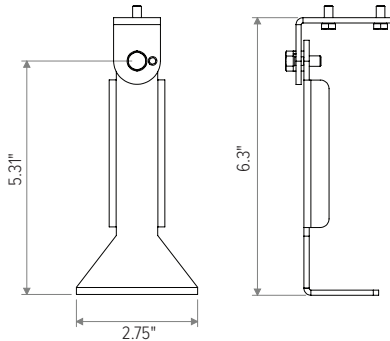

AL5056

6.3" Bracket

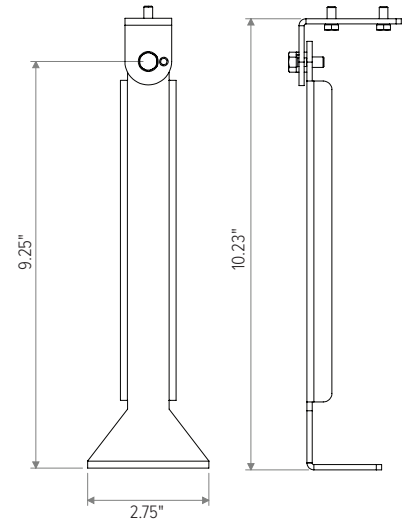

AL5057

10.23" Bracket

WALL BRACKET OPTIONS (sold separately)

The Griven Parade L Wall Bracket can be used with the Griven Parade L product family. The Wall Bracket will position the center of the Parade L optics at a distance of six inches from the wall.

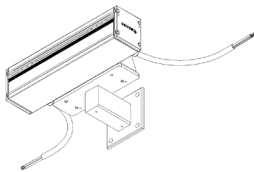

WB-06-PDL1/L2-xx* (*Specify finish)

(1) 6" Wall Bracket

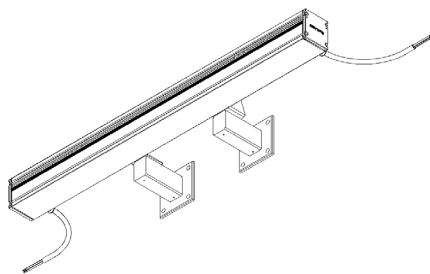
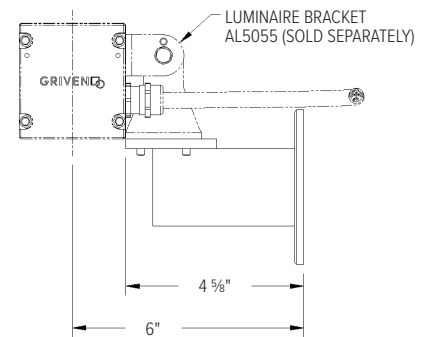
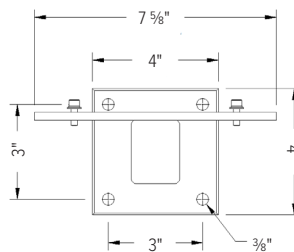

WB-06-PDL3/L4-xx* (*Specify finish)

(2) 6" Wall Bracket

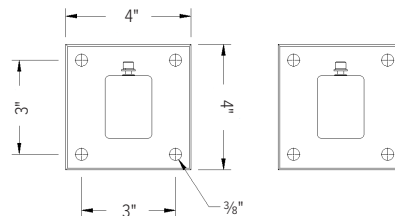

PARADE L3
9-5/8" MIN - 26-3/4" MAX
PARADE L4
15-5/8" MIN - 38-7/8" MAX

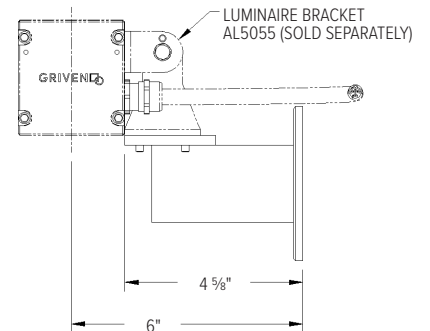

PHOTOMETRICS

Values shown are for PDL4. Multiply by 75%, 50%, and 25% respectively for PDL3, PDL2, and PDL1.

CANDELA DISTRIBUTION

SPOT 8°

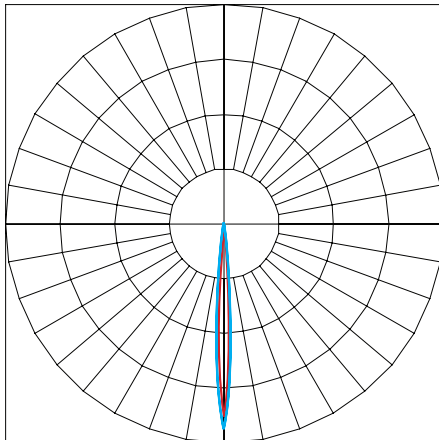

— HORIZONTAL
— VERTICAL CBCP 80722 3468 lm

NARROW 12°

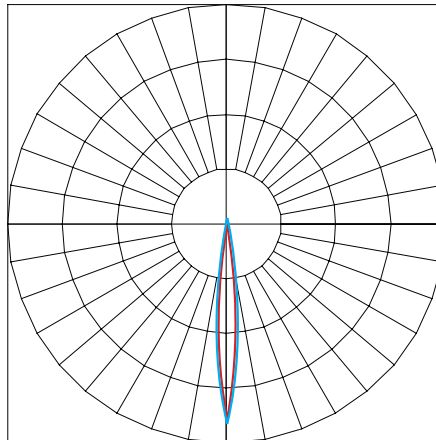

— HORIZONTAL
— VERTICAL CBCP 39491 3334 lm

MEDIUM 26°

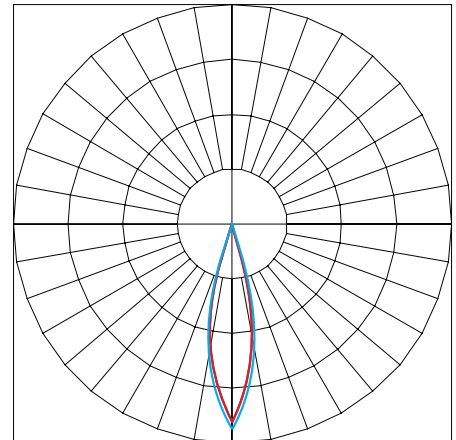

— HORIZONTAL
— VERTICAL CBCP 13443 3343 lm

WIDE 40°

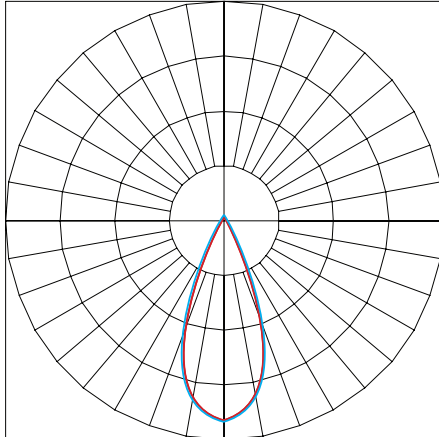

— HORIZONTAL
— VERTICAL CBCP 5501 3007 lm

ELLIPTICAL 42° X 11°

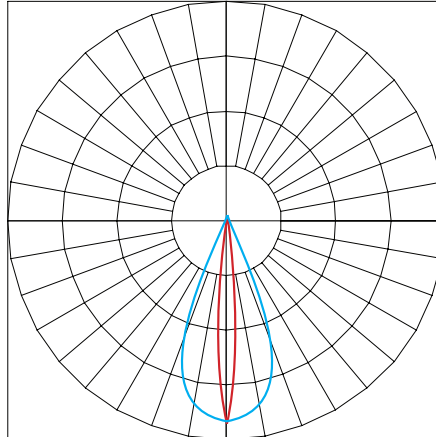

— HORIZONTAL
— VERTICAL CBCP 14058 3122 lm

ELLIPTICAL WIDE 40° X 24°

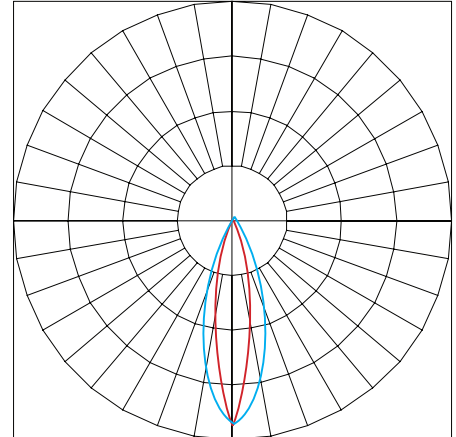

— HORIZONTAL
— VERTICAL CBCP 7397 2872 lm

CONTROL OPTIONS (DMX512, PRIMARY CONTROL PLATFORM)

Contact manufacturer for control system development.

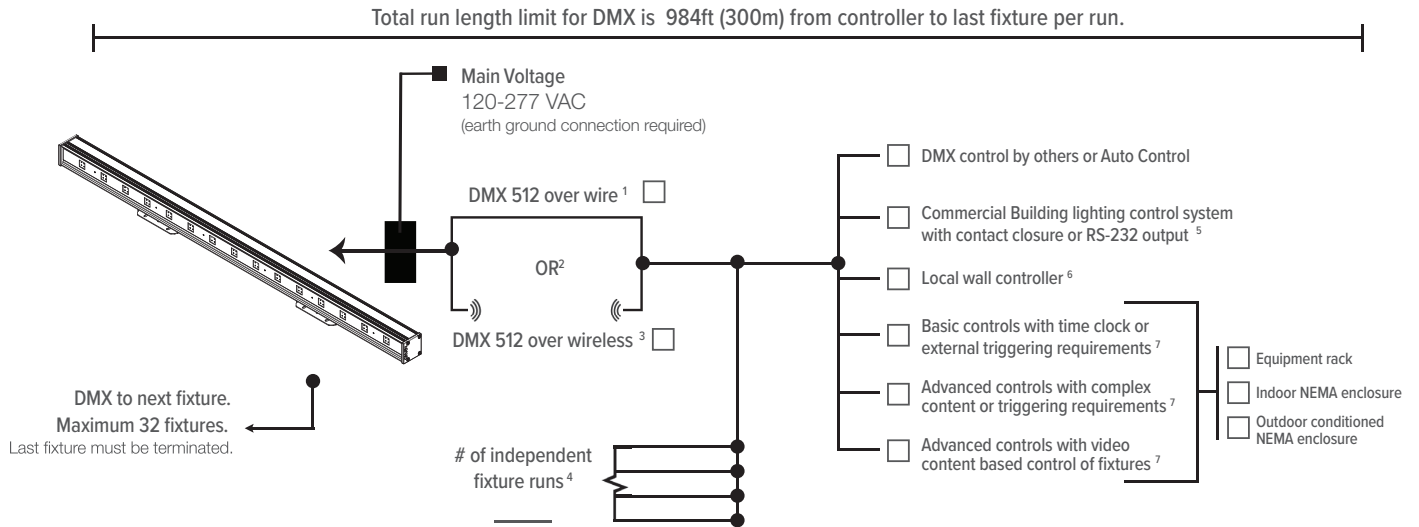

NOTES

1. Wire specifications are available from factory as well as approved wire for purchase.
2. Other control protocol solutions available. Contact factory for more information.
3. Wireless components are external to fixture. Distance limitations based on antennas chosen and site conditions. Contact factory for more information.
4. Based on maximum of 32 fixtures per run as well as any site constraints on conveyance of data.
5. For example: Lutron, Crestron, Encelium, Douglas, ETC by others. Given control system will interface with building lighting control system.
6. Local wall controller for small applications. Wall controllers specified separately for larger systems.
7. Contact factory for assistance with specification. Onsite commissioning by Given of control system is required.

ACCESSORIES

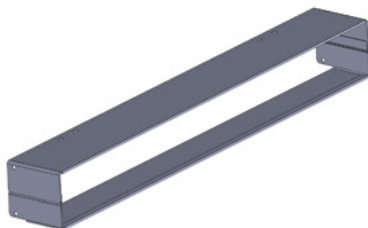

Snoot

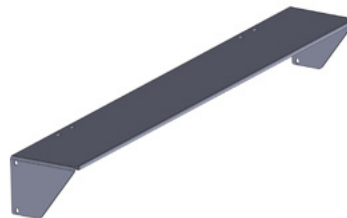

Visor